

50<sup>n</sup> puse jst 1-24

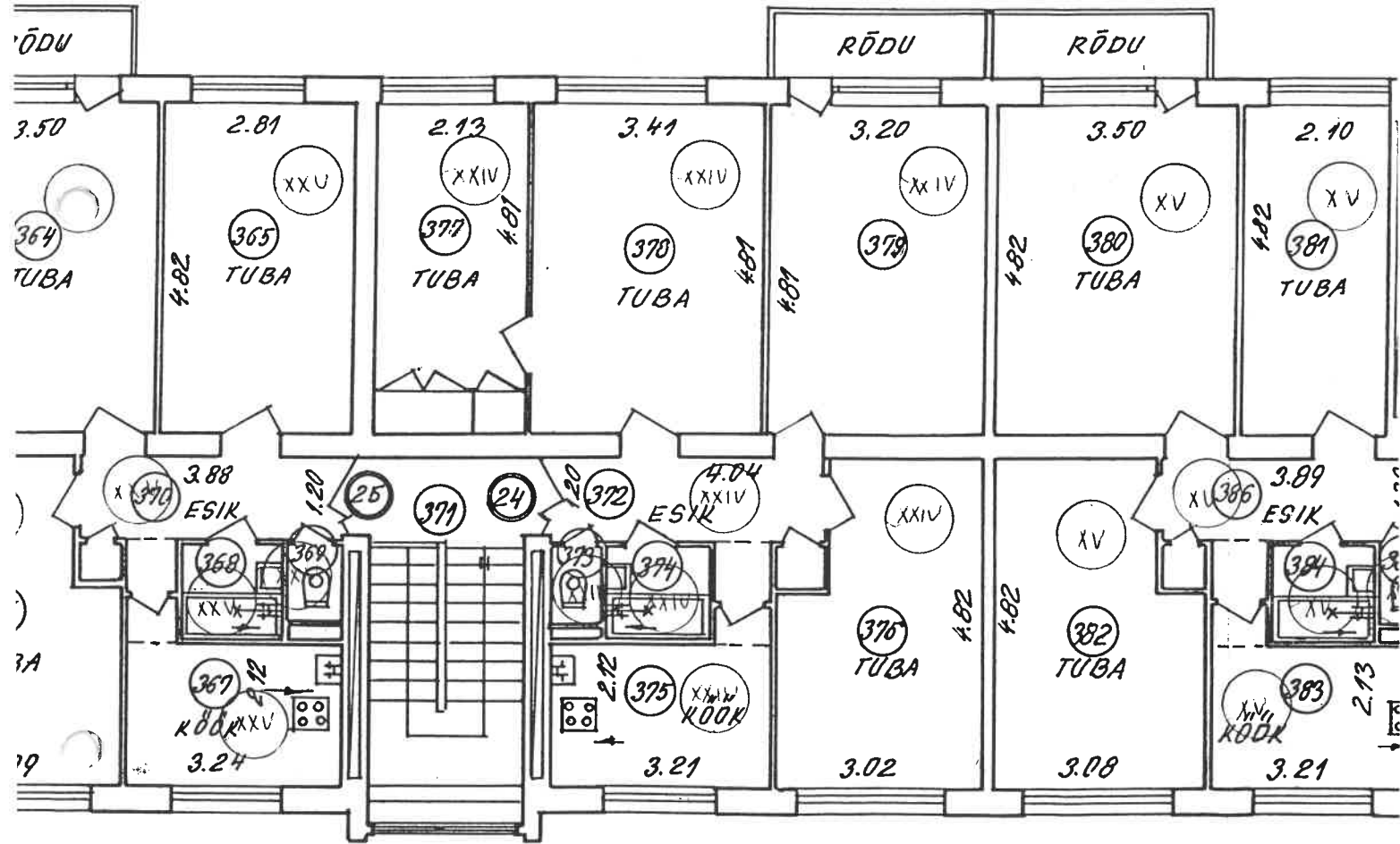

19.04.992

ARAKIRI

2	3	4	5	6	7	9	10	11
347	TUBA	$3.06 \times 4.82 - 1.98 \times 0.67$	13.4	13.4	13.4	13.4		
348	KÖÖK	$3.25 \times 2.10 + 0.77 \times 0.61$	7.3	7.3		7.3		
349	VANNITUBA	$1.52 \times 1.35$	2.1	2.1		2.1		
350	WC	$0.80 \times 1.09$	0.9	0.9		0.9		
351	ESIK	$3.90 \times 1.20 + 0.78 \times 0.81 + 0.60 \times 0.56$	5.6	5.6		5.6		
	RÖDU	$3.15 \times 0.95$						3.0
		KORTER N° 40 KOKKU:	56.3	56.3	40.4		56.3	3.0
352	TREPIKODA	$2.25 \times 5.20 - 3.85 \times 1.17$	7.2				7.2	
353	ESIK	$1.67 \times 1.21 + 0.61 \times 0.56 + 0.82 \times 1.14$	3.3	3.3			3.3	
354	VANNITUBA	$1.52 \times 1.35$	2.1	2.1			2.1	
355	WC	$0.80 \times 1.09$	0.9	0.9			0.9	
356	KÖÖK	$2.30 \times 2.32$	5.3	5.3			5.3	
357	TUBA	$3.62 \times 4.82 - 1.59 \times 1.33 + 0.55 \times 0.61$	15.7	15.7	15.7		15.7	
		KORTER N° 39 KOKKU	27.3	27.3	15.7		27.3	
358	ESIK	$3.92 \times 1.19 + 0.82 \times 0.79 + 0.52 \times 0.63$	5.6	5.6			5.6	
	WC	$0.80 \times 1.09$	0.9	0.9			0.9	
360	VANNITUBA	$1.52 \times 1.35$	2.1	2.1			2.1	
361	KÖÖK	$3.25 \times 2.10 + 0.82 \times 0.60$	7.3	7.3			7.3	
362	TUBA	$3.05 \times 4.82 - 0.65 \times 2.00$	13.4	13.4	13.4		13.4	
363	— " —	$3.47 \times 4.82$	16.7	16.7	16.7		16.7	
	RÖDU	$3.15 \times 0.95$						3.0
		KORTER N° 38 KOKKU:	46.0	46.0	30.1		46.0	3.0
364	TUBA	$3.50 \times 4.82$	16.9	16.9	16.9		16.9	
365	— " —	$2.81 \times 4.82$	13.5	13.5	13.5		13.5	
366	— " —	$3.09 \times 4.81 - 0.70 \times 1.99$	13.5	13.5	13.5		13.5	
367	KÖÖK	$3.24 \times 2.12 + 0.75 \times 0.62$	7.3	7.3			7.3	
368	VANNITUBA	$1.52 \times 1.35$	2.1	2.1			2.1	
369	WC	$0.80 \times 1.09$	0.9	0.9			0.9	
370	ESIK	$3.88 \times 1.20 + 0.75 \times 0.78 + 0.55 \times 0.56$	5.5	5.5			5.5	
	RÖDU	$3.15 \times 0.95$						3.0
		KORTER N° 25 KOKKU:	59.7	59.7	43.9		59.7	3.0
	TREPIKODA	$2.25 \times 5.20 - 3.85 \times 1.17$	7.2				7.2	
372	ESIK	$4.04 \times 1.20 + 0.80 \times 0.81 + 0.60 \times 0.69$	5.9	5.9			5.9	
373	WC	$0.80 \times 1.09$	0.9	0.9			0.9	
374	VANNITUBA	$1.52 \times 1.35$	2.1	2.1			2.1	
375	KÖÖK	$3.21 \times 2.12 + 0.80 \times 0.57$	7.3	7.3			7.3	
376	TUBA	$3.02 \times 4.82 - 0.89 \times 1.99$	12.9	12.9	12.9		12.9	
377	— " —	$2.13 \times 4.81 - 0.04 \times 2.73$	10.1	10.1	10.1		10.1	
378	— " —	$3.41 \times 4.81$	16.4	16.4	16.4		16.4	
379	— " —	$3.20 \times 4.81$	15.4	15.4	15.4		15.4	
	RÖDU	$3.15 \times 0.95$						3.0
		KORTER N° 24 KOKKU:	71.0	71.0	54.8		71.0	3.0
380	TUBA	$3.50 \times 4.82$	16.9	16.9	16.9		16.9	
381	— " —	$2.10 \times 4.82$	10.1	10.1	10.1		10.1	
382	— " —	$3.08 \times 4.82 - 0.70 \times 2.00$	13.4	13.4	13.4		13.4	
383	KÖÖK	$3.21 \times 2.13 + 0.80 \times 0.61$	7.3	7.3			7.3	
384	VANNITUBA	$1.52 \times 1.35$	2.1	2.1			2.1	
385	WC	$0.80 \times 1.09$	0.9	0.9			0.9	